



A09 DC COILS



Type of protection (in relation to connector used)	IP 65
Number of cycle	18.000/h
Supply tolerance	±10%
Ambient temperature	-30°C ÷ 60°C
Duty cycle	100% ED
Insulation class wire	H
Weight	0,215 Kg

MOUNTING COMPATIBILITY	
AD.2.E	CH. I PAGE 4
ADC.3...	CH. I PAGE 5
CDL.04...	CH. I PAGE 61
C3V.03...	BFP CARTRIDGE CAT.
CDC.3...	CH. V PAGE 2

VOLTAGE (V)	MAX WINDING TEMPERATURE (AMBIENT TEMPERATURE 25°C)	RATED POWER (W)	RESISTANCE AT 20°C (OHM) ±7%
12V	123°C	27	5.3
24V	123°C	27	21.3
48V*	123°C	27	85.3
102V*	123°C	27	392
110V*	123°C	27	448
205V*	123°C	27	1577

* SPECIAL VOLTAGES

ETA09 - 04/2001/e

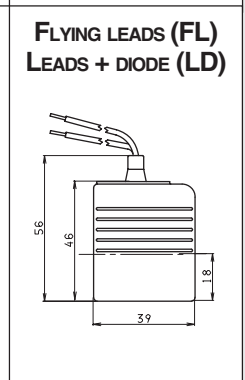
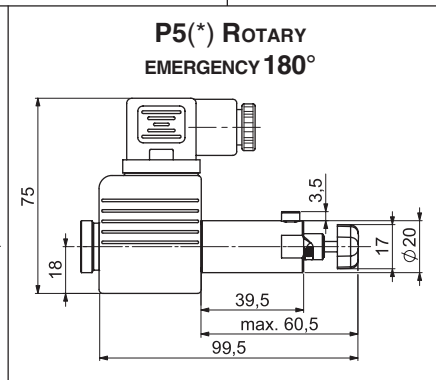
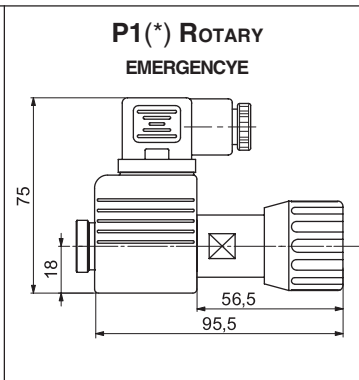
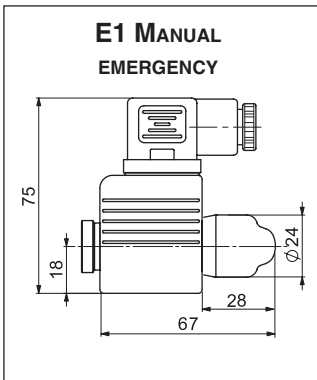
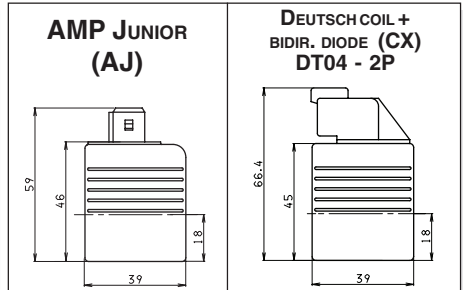

(*) P1 and P5 Emergency tightening torque max. 6÷9 Nm / 0.6 ÷ 0.9 Kgm with CH n. 22

SPARE PARTS

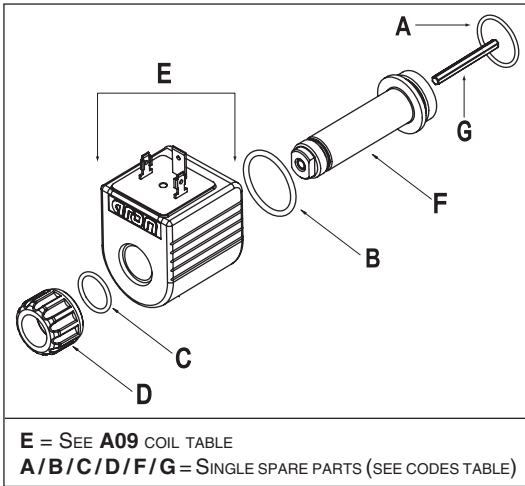

A09 DC - 27W COIL	CONNECTIONS				
	HIRSCHMANN (STANDARD) (00)	AMP JUNIOR (AJ)	FLYING LEADS + DIODE (130) (LD)	FLYING LEADS (250) (FL)	DEUTSCH + BIDIR. DIODE (CX)
12 V (L)	M14310001	M14320001	M14330001	M14070011	M14340001
24 V (M)	M14310002	M14320002	M14330002	M14070012	-
48V* (N)	M14310003				
102V* (Z)	M14310008				
110V* (P)	M14310005				
205V* (X)	M14310009				

(*SPECIAL VOLTAGES)

ETA09-CODE - 00/2007/e

COMPLETE KIT	AD2E	CDL04	ADC3	CDC3
COMPLETE SOLENOID'S TUBE	V85990008		V85990007	
P1 ROTARY EMERGENCY	V89990016		V89990017	
P5 ROTARY EMERGENCY 180°	-		V15050098	
E1 MANUAL EMERGENCY	M19050003			

CODE SPARE PARTS	A	B	C	D	E	F	G	MOUNTING AVAILABLE
	O RING			RING NUT	COIL	TUBE	HEX. PUSCH ROD	
AD2E	Q25831023	Q25830096	Q25860013	M37050036	SEE TABLE A09	M83060003	M74490001	C - E - F G - H - I - L D - M
CDL04							M74490002	
ADC3 / CDC3	Q25830024	Q25860023	M37050031	M83060004		M74460001	C - E - F G - H	
C3V03	Q25861025	Q25860024		M83060002		M74480001	-	